

# V-Flash® Modeler Packing Instructions

Assuming packaging materials and carton were retained. Modeler should be shipped in its original packaging. If other packaging is used, the customer will be responsible for any shipping damages that may occur.

- Unplug power cord from modeler.
- Remove cartridge from modeler.
- Secure actuator arm with tie wrap to ensure it doesn't move during shipment (see photos).

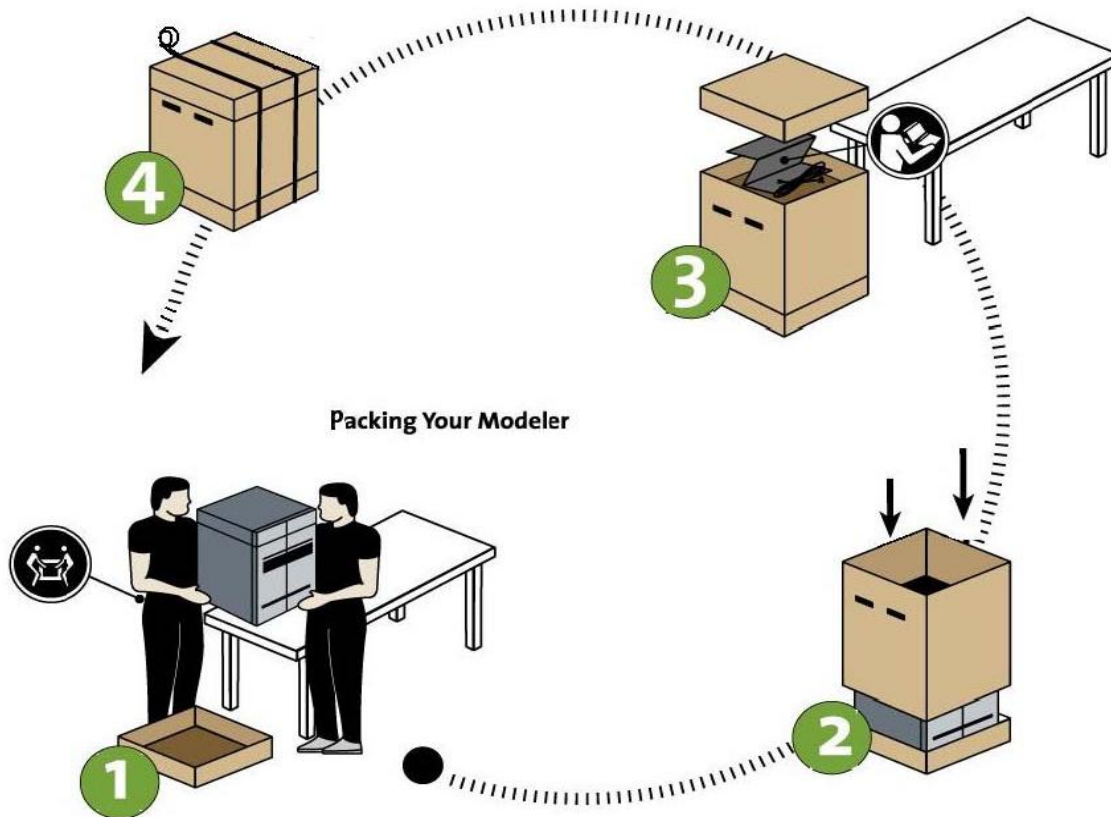
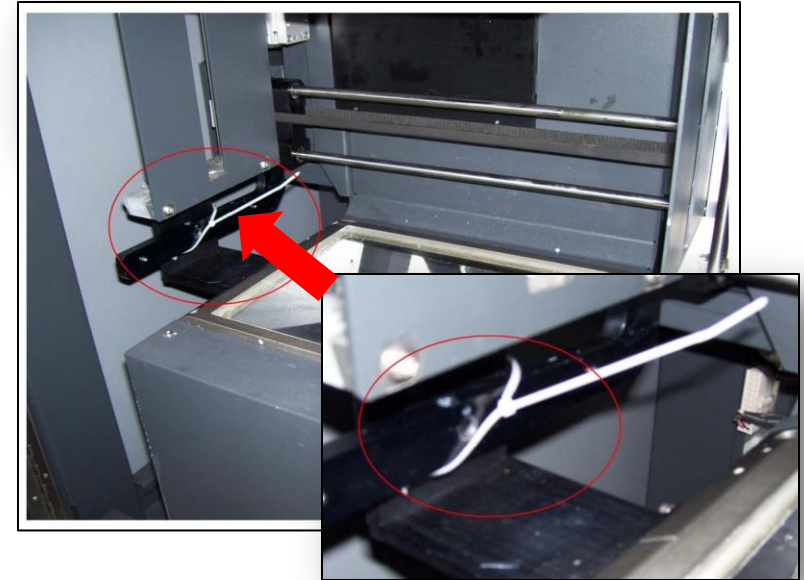

1. With assistance place modeler into carton bottom.



**Do not lift modeler from front and back ends, this could cause damage to the modeler.**

2. Reinstall box side panels over modeler.
3. Put power cord in box with modeler, put cap back on box.
4. Secure sides and cap with packing tape.